

The Optical Communications Telescope Laboratory

June 2000

The OCTL Telescope

- The Optical Communications Telescope Laboratory (OCTL) is a state-of-the-art optical communications ground terminal currently being built by the JPL Telecommunications and Mission Operations Directorate Program office. It will support bi-directional optical links and enable NASA telecommunications researchers to investigate and develop strategies for reliable high bandwidth optical communications with spacecraft.
- Construction on the OCTL building was completed in November 1999, and the 1-m coude-focus telescope is to be delivered and installed by Brashear-LP of Pittsburgh during the summer of 2001. The telescope is designed for precision pointing and tracking (< 2 arcsec rms) of LEO and deep space targets.

OCTL Beginnings

Artist's concept

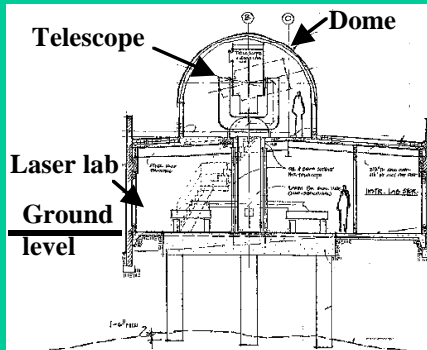

Building section

Ground breaking

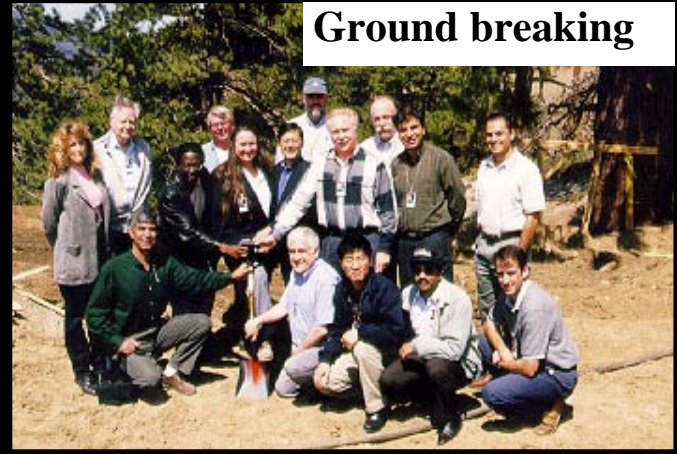

Site preparation



OCTL Floor plan

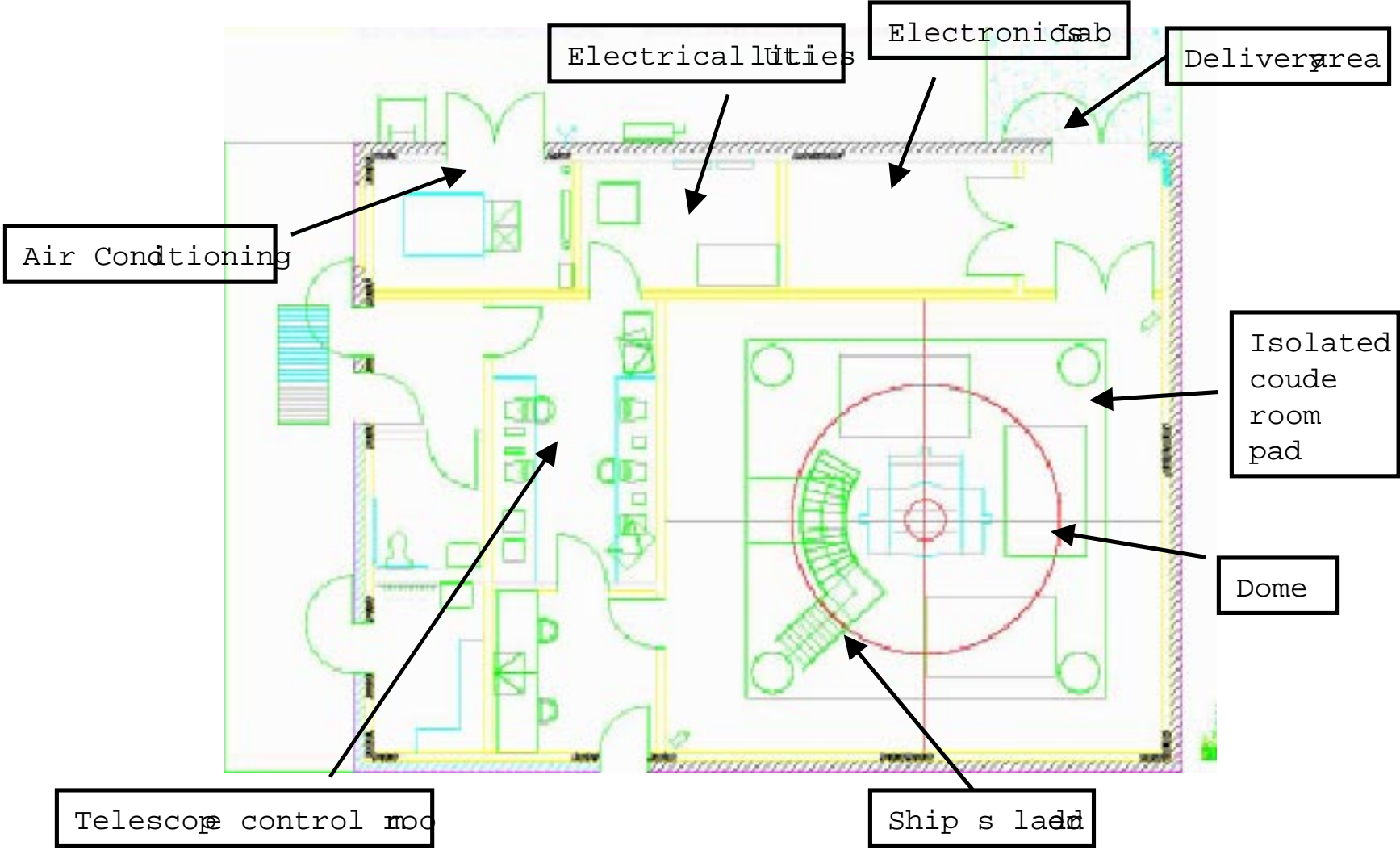

Early OCTL Building Construction

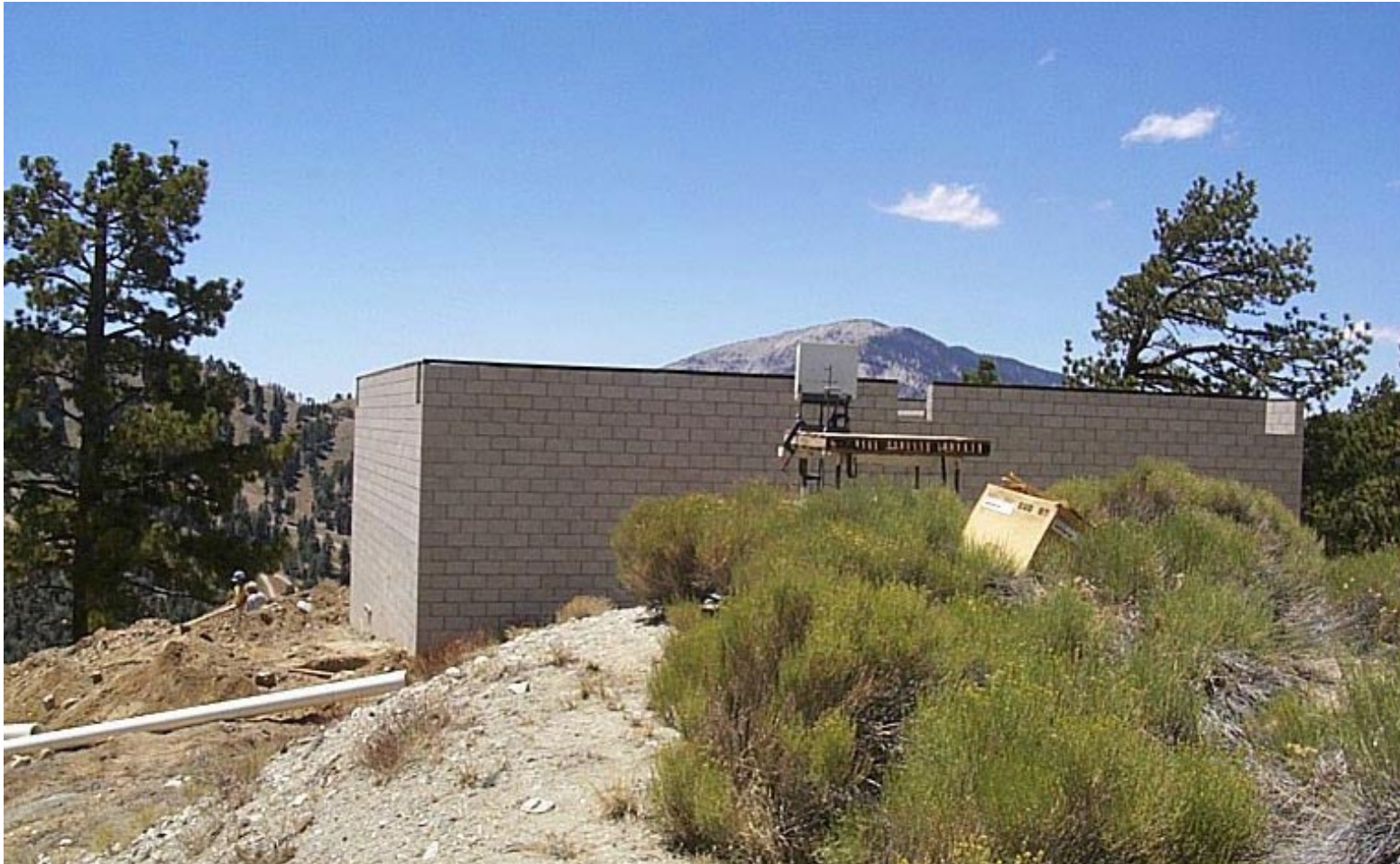

Completed OCTL Building (TM-29)



Personnel

- **Dr. N. Golshan** => **Task Manager OCTL delivery**
- **Dr. K. Wilson** => **OCTL Technical responsibility**
- **M. Britcliffe** => **Systems Engineer OCTL**
- **Dr. H. Hemmati** => **Optical Communications Group Supervisor**
- **Dr. A. Biswas** => **TMOD Work Area Manager Optical Comm**
- **Dr. J. Lesh** => **Manager TMOD Technology Program Office**